

# ASSEMBLY INSTRUCTIONS

ITEM NO.: 2638/2639-29H/49USF/29USR  
QUEEN STORAGE BED - HANOVER

Thank you for purchasing this quality product. Be sure to check all packing material carefully for small parts that may have come loose inside the carton during shipment.

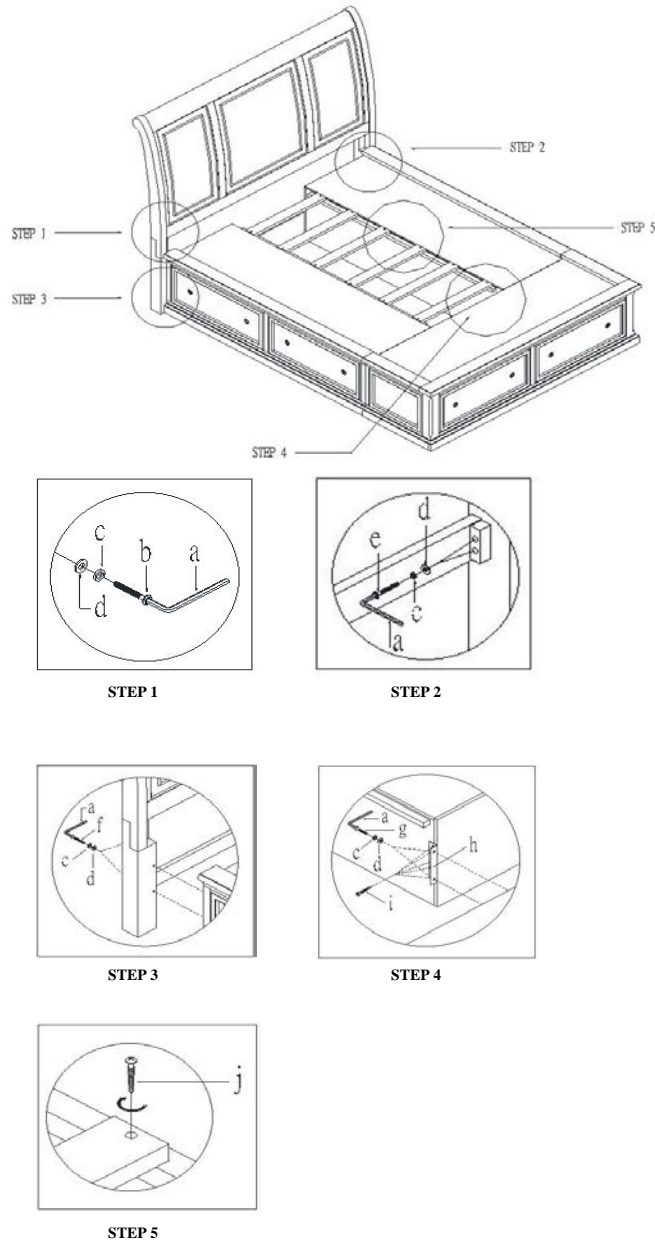

TOOLS REQUIRED (NOT PROVIDED):  
PHILLIPS SCREWDRIVER



PARTS LIST			
NO.	DESC	SKETCH	Q'TY
A	HEADBOARD		1 PC
B	STORAGE FOOTBOARD		1 PC
C	STORAGE RAILS		2 PCS
D	CROSS BAR		1 PC
E	BED SLATS		6 PCS
F	HEADBOARD POST (L + R)		2 PCS

HARDWARE LIST FOR HEADBOARD				
NO.	DESCRIPTION	SKETCH	SIZE	Q'TY
a	Allen Key		4 x 74 x 29mm	1 PC
b	Bolt		1/4" x 11.5 x 50mm	4 PCS
c	Spring Washer		1/4" x 11 x 2mm T	8 PCS
d	Flat Washer		1/4" x 18 x 2mm T	8 PCS
e	Bolt		1/4" x 11.5 x 38mm	4 PCS
k	STRAIGHT ALLEN KEY		4*100mm	1 PC

HARDWARE LIST FOR FOOTBOARD AND RAILS				
NO.	DESCRIPTION	SKETCH	SIZE	Q'TY
a	Allen Key		4 x 74 x 29mm	1 PC
c	Spring Washer		1/4" x 11 x 2mm T	8 PCS
d	Flat Washer		1/4" x 18 x 2mm T	8 PCS
f	Bolt		1/4" x 11.5 x 105mm	4 PCS
g	Bolt		1/4" x 11.5 x 25mm	4 PCS
h	"L" Metal Plate		168 x 40 x 32mm	2 PCS
i	Screw		#8 x 19mm	10 PCS
j	Screw		#8 x 30mm	12 PCS
k	STRAIGHT ALLEN KEY		4*100mm	1 PC

STEP 1: ATTACH HEADBOARD POST (F) TO THE HEADBOARD (A) BY USING ALLEN KEY (a), BOLT (b), SPRING WASHER (c) AND FLAT WASHER (d).  
STEP 2: ATTACH CROSS BAR (D) TO THE HEADBOARD POST (F) BY USING ALLEN KEY (a), BOLT (e), SPRING WASHER (c) AND FLAT WASHER (d).  
STEP 3: ATTACH STORAGE RAILS (C) TO THE HEADBOARD POST (F) BY USING ALLEN KEY (a), BOLT (f), SPRING WASHER (c) AND FLAT WASHER (d).  
STEP 4: ATTACH "L" METAL PLATE (h) TO THE STORAGE FOOTBOARD (B) AND STORAGE RAILS (C) BY USING ALLEN KEY (a), BOLT (g), SPRING WASHER (c), FLAT WASHER (d) AND SCREW (i).  
STEP 5: ATTACH SLATS (E) TO STORAGE RAILS (C) BY USING SCREW (j).

#### IMPORTANT NOTE:

- HARDWARE BAG FOR HEADBOARD IS PACKED WITH HEADBOARD.
- HARDWARE BAG FOR STORAGE FOOTBOARD AND RAILS IS PACKED WITH STORAGE FOOTBOARD.

Made In Vietnam